

WARNING: Always wash exterior of Mixer with a soft cloth, mild soap or detergent, and water. Do **NOT** hose or pressure wash machine as damage to internal electrical components may occur.

Disassembling and cleaning your Mixer

1. Use crank lever on right side of machine to lower bowl (A).
2. Open safety cages (B).
3. Remove mixing accessory by rotating base of part until it is able to be lowered.
4. Release bowl locking levers by rotating handle away from bowl (C).
5. Remove safety cages by lightly lifting the mounting rod out of the mounting bracket (D).
6. Once all parts are removed (E) clean with soft cloth, mild soap or detergent, and water.
7. After cleaning and reassembly ensure that bowl locking levers are rotated back toward the bowl.

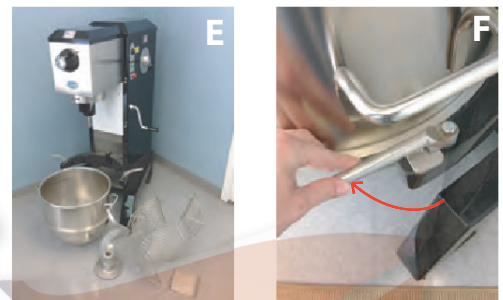
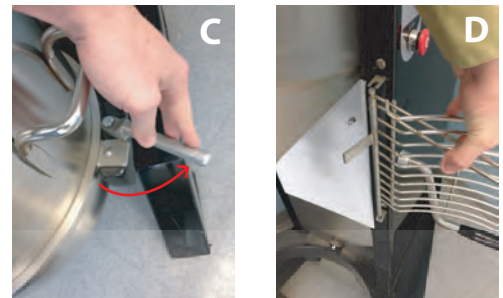
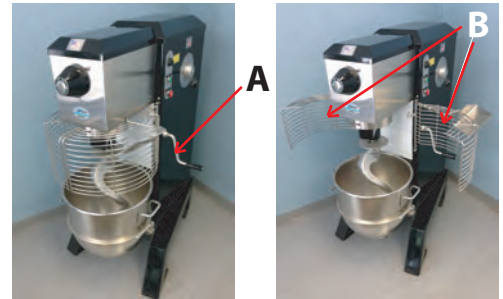

Sanitizing your Mixer

The sanitizer used shall comply with Section 4-501.114, Manual and Mechanical Warewashing Equipment, Chemical Sanitation – Temperature, pH, Concentration and Hardness of the FDA Food Code.

This machine shall be cleaned and sanitized at intervals to comply with national, state and/or local health codes. Cleaning and sanitizing shall be performed under the guidelines of this manual.

Apply the sanitizer solution according to the container's instructions to all previously washed locations and surfaces. Pay special attention to food contact zones and splash zones. Sanitize the parts that were previously removed for washing and reassemble back on to the mixer in the reverse order they were removed in the above Cleaning Instructions (steps a - f). The mixer can now safely be plugged back in to the power source and returned to operation.

Tips for keeping your Mixer clean and sanitary

- Follow all the steps in this procedure and post this document in a viewable area above your mixer.
- Always hand wash the mixer and its components.
- Never hose rinse or use excessive amounts of water. Damage may occur to the electrical components resulting in voiding the warranty.
- Follow the guidelines of your specific sanitizer solution.
- If any part of your mixer appears to be compromised, remove the mixer from service and contact Univex service.